

DIRECT SUPPORT AND GENERAL SUPPORT MAINTENANCE

REPAIR PARTS AND SPECIAL TOOLS LIST

(INCLUDING DEPOT MAINTENANCE

REPAIR PARTS AND SPECIAL TOOLS)

FOR

TELESCOPE STRAIGHT: M103

(1240-788-1236)

Current as of 30 September 1971

TABLE OF CONTENTS

		Page	Illus Figure
Section	I. Introduction	3	
	II. Repair parts list	8	
Group	2242 Telescope, M103-7659740	8	2
	2242.1 Eyepiece assembly - 7659741 and housing - 7659745	10	3
	w / related parts		
	2242.2 Cell assembly - 8634481	12	4
	2242.3 Cell assembly - 8634482	14	5
	2242.4 Cell assembly -7659742 and prism assembly - 7659743	16	6
	w/related parts		
	III. Special tools list	18	7,8
	2242.5 Clamp assembly - 7659949	20	9
Group	2615 Light instrument M54 -8246214.. . . .	22	10
	IV. Federal stock number and reference number index	24	

* This manual supersedes TM 9-1240-259-35P dated 31 July 1961 including all changes.

LIST OF ILLUSTRATIONS

<i>Illustration</i>	<i>Figure</i>
Telescope M103	1
Telescope M103	2
Eyepiece assembly and housing w / related parts	3
Cell assembly	4
Cell assembly	5
Cell assembly and prism assembly w / related parts	6
Adapter, test	7
Carrying case, telescope	8
Clamp assembly	9
Light, instrument M54	10

Section I. INTRODUCTION

1. Scope.

This manual lists repair parts, special tools, and support equipment required for the performance of direct support, general support and depot maintenance of the telescope, M103.

2. General

This Repair Parts and Special Tools List is divided into the following sections:

a. Repair Parts List-Section II. A list of repair parts authorized at the direct support, general support, and depot levels for the performance of maintenance. This list also includes parts which must be removed for the replacement of the authorized parts. Parts lists are composed of functional groups in ascending numerical sequence, with parts in each group listed in figure and item number sequence.

b. Special Tools List-Section III. A list of special tools, test and support equipment authorized for the performance of maintenance at the direct support, general support and depot levels.

c. Federal Stock Number and Reference Number Index-Section IV. A list, in ascending numerical sequence, of all Federal stock numbers appearing in the listings followed by a list, in alphameric sequence, of all reference numbers appearing in the listings. Federal stock number and reference numbers are cross-referenced to each illustration figure and item number appearance.

3. Explanation of Columns.

The following provides an explanation of columns found in the tabular listings.

a. Source, Maintenance, and Recoverability Codes (SMR).

(1) *Source Code.* Indicates the source for the listed items. Source codes are:

<i>Code</i>	<i>Explanation</i>
P	Repair parts, special tools, and test equipment supplied from the GSA/DSA, or Army supply system, and authorized for use at indicated maintenance categories.
P2	Repair parts, special tools, and test equipment which are procured and stocked for insurance purposes because the combat or military essentiality of the end item dictates that a minimum quantity be available in the supply system.
P9	Assigned to items which are NSA design controlled: unique repair parts, special tools, test, measuring and diagnostic equipment, which are stocked and supplied by the Army COMSEC Logistic System and which are not subject to the provisions of AR 380-41.
P10	Assigned to items which are NSA design controlled: special tools, test, measuring and diagnostic equipment for COMSEC support

which are accountable under the provisions of AR 380-41, and which are stocked and supplied by the Army COMSEC Logistic System.

M	Repair parts, special tools and test equipment which are not procured or stocked as such in the supply system but are to be manufactured at indicated maintenance levels.
A	Assemblies which are not procured or stocked as such but are made up of two or more units. Such component units carry individual stock numbers and descriptions, are procured and stocked separately, and can be assembled to form the required assembly at indicated maintenance categories.
X	Parts and assemblies that are not procured or stocked because the failure rate is normally below that of the applicable end item or component. The failure of such part or assembly should result in retirement of the end item from the supply system.
X1	Repair parts which are not procured or stocked. The requirement for such items will be filled by the next higher assembly or component.
X2	Repair parts, special tools and test equipment which are not stocked and have no foreseen mortality. The indicated maintenance category requiring such repair parts will attempt to obtain the parts through cannibalization or salvage. The item may be requisitioned, with exception data, from the end item manager for immediate use.
G	Major assemblies that are procured with PEMA funds for initial issue only as exchange assemblies at DS and GS level. These assemblies will not be stocked above DS and GS level or returned to depot supply level.

Note. Cannibalization or salvage may be used as a source of supply for any items source coded above except those coded X 1 and aircraft support items as restricted by AR 700-42.

(2) *Maintenance Code.* Indicates the lowest category of maintenance authorized to install the repair part and / or use the special tool or test equipment for each application. Capabilities of higher maintenance categories are considered equal or better. Maintenance codes are:

<i>Code</i>	<i>Explanation</i>
C	Crew/operator
O	Organizational maintenance
F	Direct support maintenance
H	General support maintenance
D	Depot maintenance

(3) *Recoverability Code.* Indicates whether unserviceable items should be returned for recovery or salvage. Items not coded are nonrecoverable. Recoverability codes are:

<i>Code</i>	<i>Explanation</i>
	Repair parts (assemblies and components), special tools and test equipment which are considered economically repairable at direct and

general support maintenance levels. When the item is no longer economically repairable, it is normally disposed of at the GS level. When supply considerations dictate, some of these repair parts may be listed for automatic return to supply for depot level repair as set forth in AR 710-50. When so listed, they will be replaced by supply on an exchange basis.

Repair parts, special tools and test equipment, and assemblies which are economically repairable at DS and GS activities and which normally are furnished by supply on an exchange basis. When items are determined by a GSU to be uneconomically repairable, they will be evacuated to a depot for evaluation and analysis before final disposition.

High dollar value recoverable repair parts, special tools and test equipment which are subject to special handling and are issued on an exchange basis. Such items will be repaired or overhauled at depot maintenance activities only. No repairman be accomplished at lower levels.

Repair parts, special tools and test equipment specifically selected for salvage by reclamation units because of precious metal content, critical materials, high dollar value, or reusable casings or castings.

b. Federal Stock Number. Indicates the Federal stock number assigned to the item and will be used for requisitioning purposes.

c. Description. Indicates the Federal item name and a minimum description required to identify the item. The last line indicates the reference number followed by the applicable Federal Supply Code for Manufacturer (FSCM) in parentheses. The FSCM is used as an element in item identification to designate manufacturer or distributor or Government Agency, etc., and is identified in SB 708-42.

d. Unit of Measure (U/M). Indicates the standard or basic quantity by which the listed item is used in performing the actual maintenance function. This measure is expressed by a two-character alphabetical abbreviation, e.g., ea, in, pr, etc., and is the basis used to indicate quantities and allowances in subsequent columns. When the unit of measure differs from the unit of issue, the lowest unit of issue that will satisfy the required units of measure will be requisitioned.

e. Quantity Incorporated in Unit. Indicates the quantity of the item used in the breakout shown in the illustration figure, which is prepared for a functional group, subfunctional group, or an assembly. A "V" appearing in this column in lieu of a quantity indicates that no specific quantity is applicable, e.g., shims, spacers, etc.

f. 30-Day DS/GS Maintenance Allowances.

Note: Allowances in GS Column are for GS maintenance only

(1) The allowance columns are divided into three subcolumns. Indicated in each subcolumn, opposite the first appearance of each item in each category of maintenance, is the total quantity of items authorized for the number of equipments

supported. Subsequent appearances of the same item will have the letters "REF" in the applicable allowance columns, indicating total allowance quantities will be shown with the first appearance of the item when shown as a supply item. Items authorized for use as required but not for initial stockage are identified with an asterisk in the allowance column.

(2) The quantitative allowances for DS/GS levels of maintenance will represent initial stockage for a 30-day period for the number of equipments supported.

(3) Determination of the total quantity of parts required for maintenance of more than 100 of these equipments can be accomplished by converting the equipment quantity to a decimal factor by placing a decimal point before the next to last digit of the number to indicate hundredths and multiplying the decimal factor by the parts quantity authorized in the 51-100 allowance column. Example: authorized allowance for 51-100 equipments is 40; for 150 equipments multiply 40 by 1.50 indicating 60 parts required.

g. 1-Year Allowances Per 100 Equipments / Contingency Planning Purposes. This column indicates opposite the first appearance of each item the total quantity required for distribution and contingency planning purposes. Subsequent appearances of the same item will have the letters "REF" in this column when shown as a supply item. The range of items indicates total quantities of all authorized items required to provide for adequate support of 100 equipments for one year.

h. Depot Maintenance Allowance Per 100 Equipments. This column indicates opposite the first appearance of each item the total quantity authorized for depot maintenance of 100 equipments. Subsequent appearances of the same item will have the letters "REF" in this column when shown as a supply item. Items authorized for use but not for initial stockage are identified with an asterisk in the allowance column.

i. Illustration. This column is divided as follows :

(1) Figure Number. Indicates the figure number of the illustration on which the item is shown.

(2) Item Number. Indicates the callout number used to reference the item on the illustration.

4. Special Information.

a. Action change codes indicated in the left-hand margin of the listing page denote the following:

N-Indicates an added item.

C-Indicates a change in data.

R-Indicates a change in FSN only.

b. The following publication pertains to telescope, M103:

TM 9-1015-223-12 **Operator and Organizational Maintenance Manual: (Including Repair Parts and Special Tools List) Rifle, Recoilless 90mm, M67.**

c. To maintain disassembly sequence in this manual, a sequence number in parentheses will be displayed immediately to the right of the callout number on the illustration.

d. Detailed assembly instructions for items source coded "A" are found in TM 9-1240-259-35.

5. How to Locate Repair Parts.

a. When Federal stock number or reference number is unknown:

(1) *First.* Using the table of contents determine the functional or subfunctional group within which the repair part belongs, i.e. engine, engine assembly, transmission, transmission assembly. This is necessary since illustrations are prepared for functional and subfunctional groups, and listings are divided into the same groups.

(2) *Second.* Find the illustration covering the functional or subfunctional group to which the repair part belongs.

(3) *Third.* Identify the repair part on the illustration and note the illustration figure and item number of the repair part.

(4) *Fourth.* Using the Repair Parts Listing, find the functional or subfunctional group to which the repair part belongs and locate the illustration figure and item number noted on the illustration.

b. When Federal stock number or reference number is known:

(1) *First.* Using the index of Federal Stock Numbers and Reference Numbers find the pertinent Federal stock number or reference number. This index is in ascending FSN sequence followed by a list of reference numbers in ascending alphameric sequence, cross-referenced to the illustration figure number and item number.

(2) *Second.* Using the Repair Parts Listing, find the functional or sub functional group of the repair part and the illustration figure number and item number referenced in the Index of Federal Stock Numbers and Reference Numbers.

6. Abbreviations.

<i>Abbreviations</i>	<i>Explanation</i>
al	aluminum
amp	amperage
b	base
cmpd	compound
cp	cone point
crs	corrosion resistant steel
dia	diameter
dr	drive
fnsh	finish
fp	flat point
fr	frame
filh	fillister head
gl	glass
hdls	headless
hex	hexagon
hlcl	helical
id	inside diameter
l	long
nf	national fine
oa	over-all
od	outside diameter
pnh	pan head
psvt	passivate
pt	point
rbr	rubber
rec	recessed
rtnr	retainer
scr	screw
sep	separator
skt	socket
sld	slotted
spl	spiral
spr	spring
stl	steel
str	straight
thd	thread
thk	thick
unc	unified coarse thread
unf	unified fine thread
uns	unified special thread
w/o	without

7. Recommendations for Maintenance Publications Improvements.

You can improve this manual by calling attention to errors and by recommending improvements, using DA Form 2028 (Recommended Changes to Publications) or by a letter, and mailing directly to Commanding Officer, Frankford Arsenal, ATTN: AMSWE-MAF-W3100, Philadelphia, Pennsylvania 19137. A reply will be furnished directly to you.

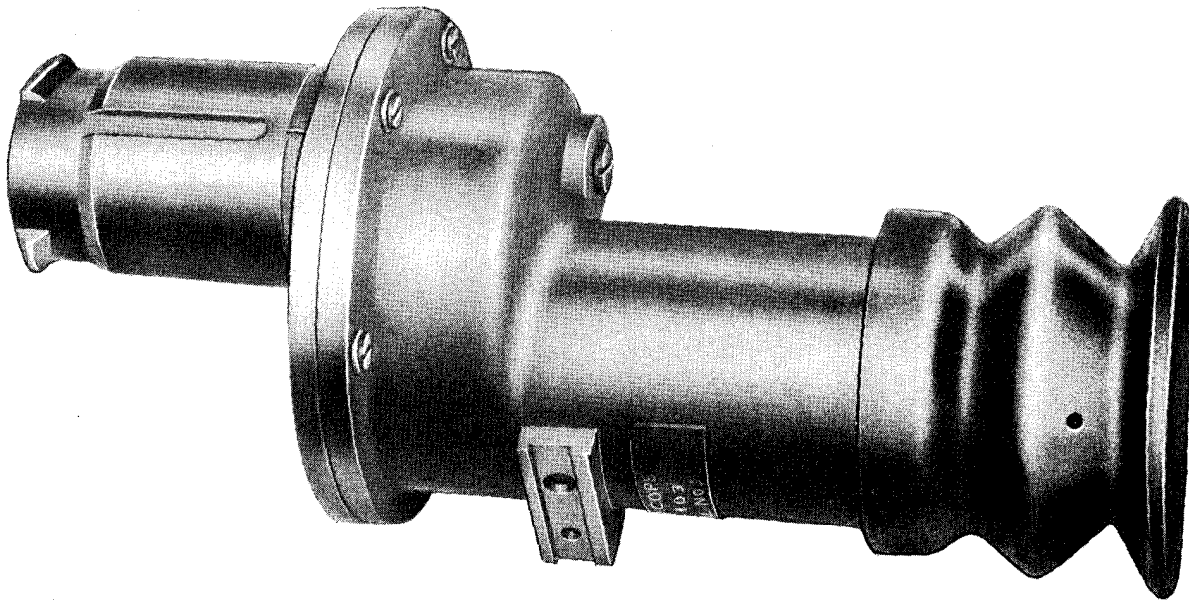

WE 55077

Figure 1. Telescope M103

SECTION II. REPAIR PARTS LIST

ACT ON CODE	(1) SOURCE MAINT AND (A) (B) (C) SOURCE MAINT RECOV			(2) FEDERAL STOCK NO.	(3) DESCRIPTION REFERENCE NUMBER & MFR CODE	(4) UNIT OF MEAS	(5) QTY INC IN UNIT	(6) 30-DAY DS MAINT ALLOWANCE (A) (B) (C) 1-20 21-50 51-100			(7) 30-DAY GS MAINT ALLOWANCE (A) (B) (C) 1-20 21-50 51-100			(8) 1-YR ALW PER 100 EQUIP CNTGCTY	(9) DEPOT MAINT ALW PER 100 EQUIP	(10) ILLUSTRATION (A) (B) FIGURE ITEM NO. NO.	
						TELESCOPE M103 7659740											
C	P-	O-		1240-812-1754	EYESHIELD OPTICAL INSTRUMENT RU,1-1/4 VIEWING ID, 1-27/32 O/A L 8634483 (19200)	EA	1	*	*	*	*	*	*	*	*	2	1
N	P-	D-		5305-057-0511	SCREW MACHINE NO 4-48 UNF-2A,5/16L MS51958-14 (96906)	EA	5								*	2	2
N	P-	D-		5310-933-8118	WASHER LOCK SPR,HLCL,CRES,PSVT,FNSH 0.115 ID,0.204 OD,0.025 THK NO 4 SCR MS35338-135 (96906)	EA	5								*	2	3
N	P-	D-			PIN STR STL DR, 0.0622 DIA, 0.250 L MS51838-2 (96906)	EA	2								*	2	4
N	P-	D-		5305-050-9225	SCREW,MACHINE PNH,CROSS REC,CRES,PSVT FNSH NO. 10-24UNC-2A,1/4 L MS51957-59 (96906)	EA	1								*	2	5

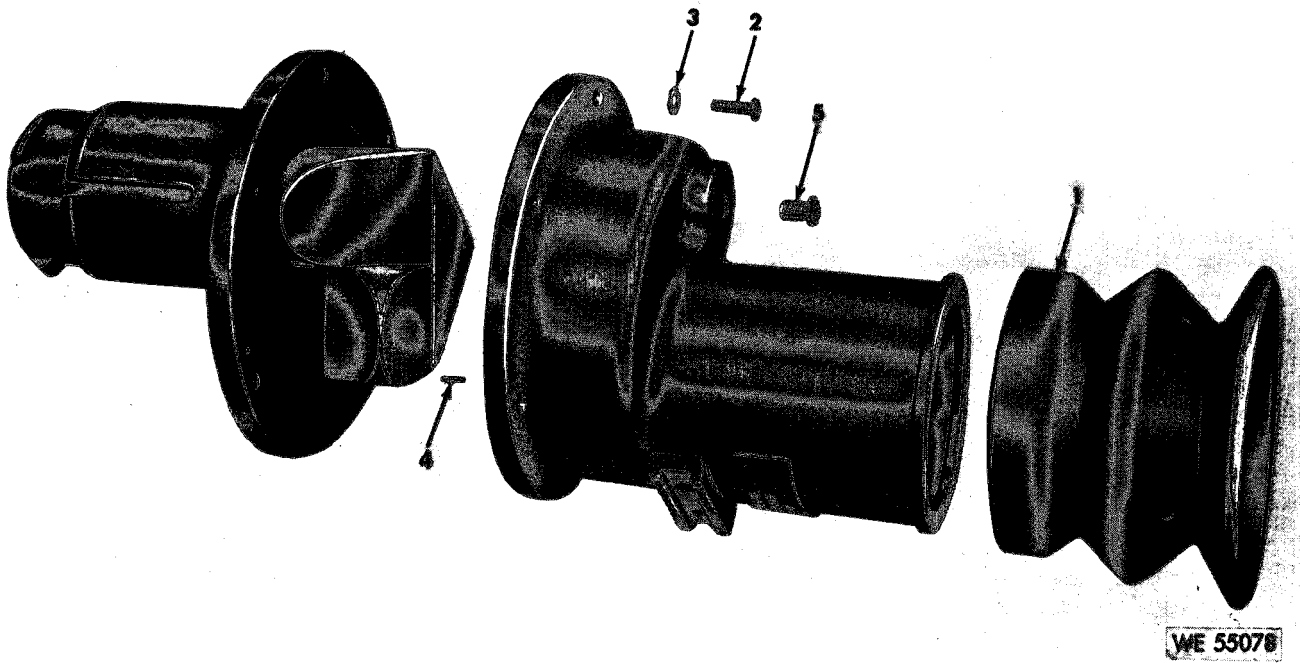

Figure 2. Telescope M103

ACT ON CODE	(1) SOURCE MAINT AND RECOV CODE (A) (B) (C) SOURCE MAINT RECOV			(2) FEDERAL STOCK NO.	(3) DESCRIPTION REFERENCE NUMBER & MFR CODE USABLE ON CODE	(4) UNIT OF MEAS	(5) QTY INC IN UNIT	(6) 30-DAY DS MAINT ALLOWANCE (A) (B) (C) 1-20 21-50 51-100			(7) 30-DAY GS MAINT ALLOWANCE (A) (B) (C) 1-20 21-50 51-100			(8) 1-YR ALW PER EQUIP CNTGCTY	(9) DEPOT MAINT ALW PER EQUIP	(10) ILLUSTRATION (A) (B) FIGURE ITEM NO. NO.		
					EYEPiece ASSEMBLY 7659741 AND HOUSING 7659745 W/RELATED PARTS													
N	P-	D-		5305-068-6708	SETSCREW HEX,SOC,CP,CRES,PSVT NO. 2-64UNF-3A,1/8 L MS51038-16 (96906)	EA	2								*	3	1	
N	A-	-			EYEPiece ASSEMBLY 7659741 (19200)		1										3 2	
C	P-	D-		5305-753-7062	SETSCREW HDLS,SLOT DR CP,CRES NO. 2-64 NF-2A 1/16 L 541823 (00000)	EA	2								*	3	3	
C	P-	D-		1240-812-1752	CELL ASSEMBLY OPTICAL INSTRUMENT AL,1-15/32 O/A DIA, 3/4 O/A L 1-5/32-32UNS-2A,1 RETICLE TYPE W/RTNR 8634482 (19200)	EA	1								*	3	4	
C	P-	D-		1240-815-8187	CELL ASSEMBLY OPTICAL INSTRUMENT SL,1.280 O/A DIA, 1.580 O/A L, 1-5/32-32UNS-2B,2 CMPD LENS TYPE W/RTNR AND SEP 8634481 (19200)	EA	1								*	3	5	
N	P-	D-		1240-150-1559	RETAINER 7660663 (19200)	EA	1								*	3	6	
N	P-	D-		1240-504-9890	WINDOW OBSERVATION GL RED,0.180 O/A DIA,0.035 O/A THK,W/O FR 5049890 (19200)	EA	1								*	3	7	
N	P-	D-		9905-454-9020	PLATE, IDENTIFICATION 7659753 (19200)	EA	1								*	3	8	
N	X-	-			HOUSING 7659745 (000000)		1										3 9	

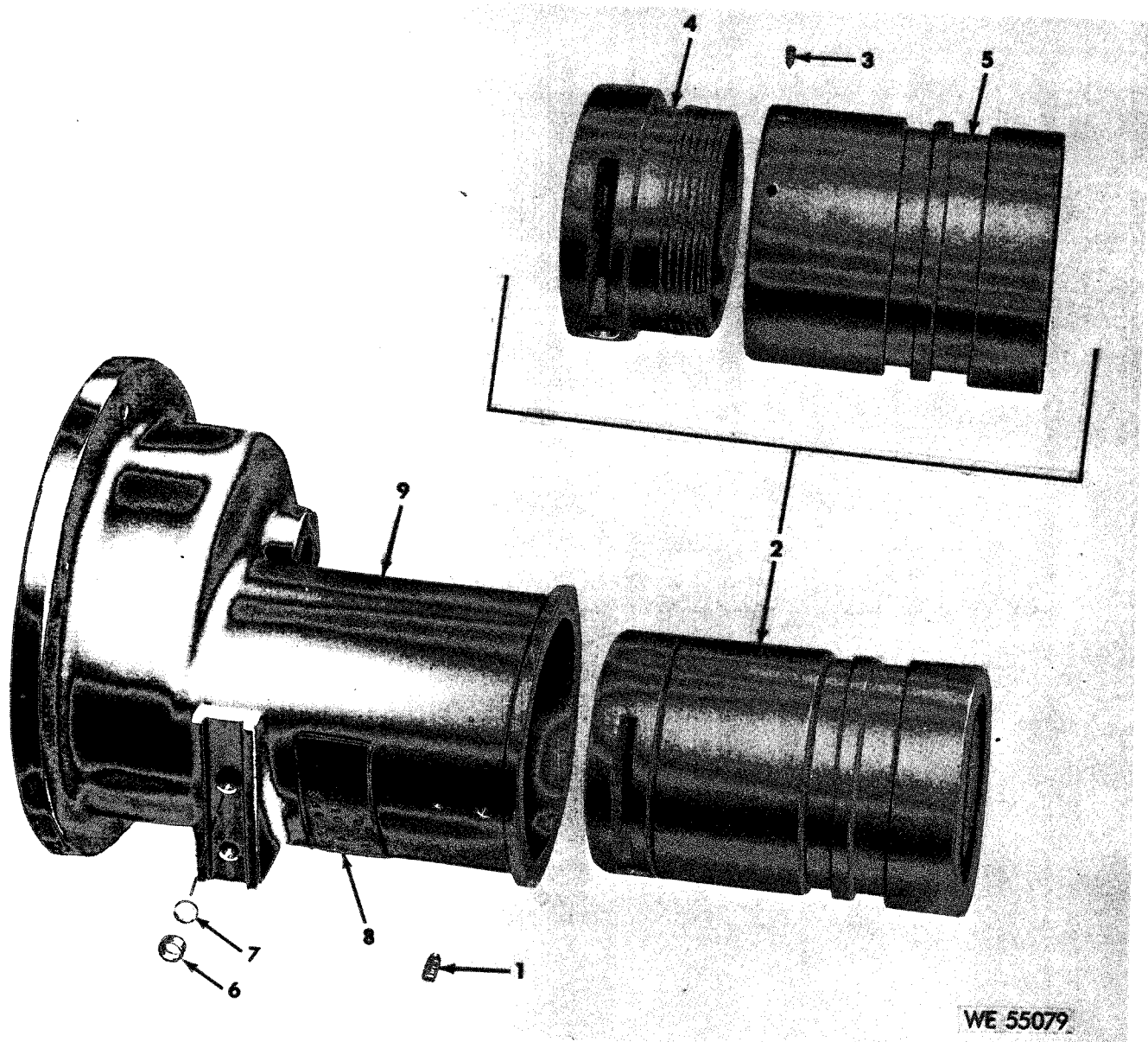

Figure 3. 1

ACT ON CODE	(1) SOURCE MAINT AND RECOV CODE (A) (B) (C) SOURCE MAINT RECOV			(2) FEDERAL STOCK NO.	(3) DESCRIPTION REFERENCE NUMBER & MFR CODE	(4) UNIT OF MEAS	(5) QTY INC IN UNIT	(6) 30-DAY DS MAINT ALLOWANCE			(7) 30-DAY GS MAINT ALLOWANCE			(8) 1-YR ALW PER 100 EQUIP CNTGCV	(9) DEPOT MAINT 100 ALW PER EQUIP	(10) ILLUSTRATION	
	(A)	(B)	(C)					(A)	(B)	(C)	(A)	(B)					
	1-20	21-50	51-100					1-20	21-50	51-100	FIGURE NO.	ITEM NO.					
N	X2-	D-			RETAINER 7659748 (00000)	EA	1									4	1
N	X1-	-			LENS,OPTICAL 7659761 (19200)		2									4	2
N	X2-	D-			SPACER 7659747 (00000)	EA	1									4	3
N	X1-	-			CELL 7659746 (19200)		1									4	5

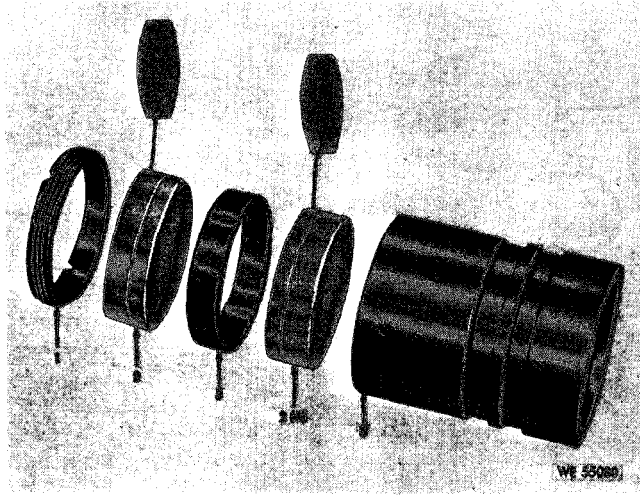

Figure 4. Cell assembly

ACT ON CODE	(1) SOURCE MAINT AND RECOV CODE (A) (B) (C) SOURCE MAINT RECOV			(2) FEDERAL STOCK NO.	(3) DESCRIPTION REFERENCE NUMBER & MFR CODE	(4) UNIT OF MEAS	(5) QTY INC IN UNIT	(6) 30-DAY DS MAINT ALLOWANCE			(7) 30-DAY GS MAINT ALLOWANCE			(8) 1-YR ALW PER 100 EQUIP CNTGCTY	(9) DEPOT MAINT 100 ALW PER EQUIP	(10) ILLUSTRATION FIGURE (A) (B) NO. NO.	
	(A)	(B)	(C)					(A)	(B)	(C)	(A)	(B)	(C)	(A)	(B)		
N	X2-	D-			RETAINER 7659750 (19200)	EA	1									5	1
N	X1-	-			RETICLE 7659755 (00000)		1									5	2
N	X1-	-			VIAL 7659759 (19200)		1									5	3
N	X1-	-			CELL 7659749 (19200)		1									5	4

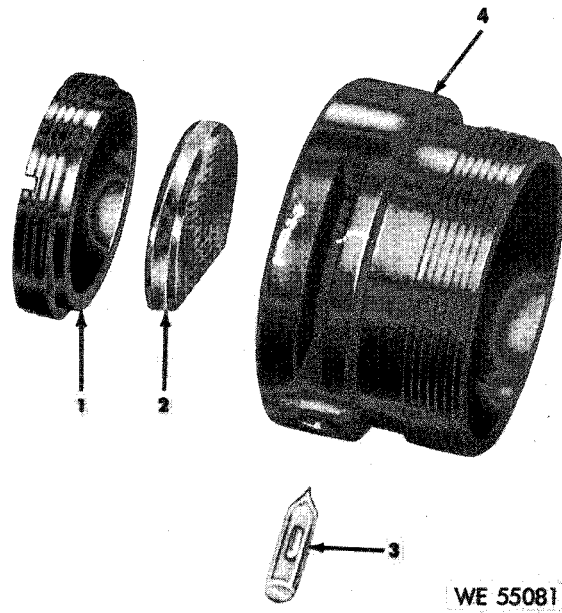

Figure 5. Cell assembly

ACT ON CODE	(1) SOURCE MAINT AND RECOV CODE (A) (B) (C) SOURCE MAINT RECOV			(2) FEDERAL STOCK NO.	(3) DESCRIPTION REFERENCE NUMBER & MFR CODE	(4) UNIT OF MEAS	(5) QTY INC IN UNIT	(6) 30-DAY DS MAINT ALLOWANCE (A) (B) (C) 1-20 21-50 51-100			(7) 30-DAY GS MAINT ALLOWANCE (A) (B) (C) 1-20 21-50 51-100			(8) 1-YR ALW PER EQUIP CNTGCTY	(9) DEPOT MAINT ALW PER EQUIP	(10) ILLUSTRATION (A) (B) FIGURE ITEM NO. NO.			
					CELL ASSEMBLY 7659742 AND PRISM ASSEMBLY 7659743 W/RELATED PARTS														
C	P-	D-		5305-527-5737	SETSCREW HDLS SKT DR, FP CRES NO 4-48UNF3-A, 1/8 L MS51031-16 (96906)	EA	2								*	6	1		
C	P-	D-		5305-851-2287	SETSCREW HEX, SOC, CUP PT, CRES, PSVT FNSH NO. 4-48NF-3A, 1/8 L MS51024-18 (96906)	EA	2								*	6	2		
C	P-	D-		1240-812-1751	CELL ASSEMBLY OPTICAL INSTRUMENT AL, 1-1/8 O/A DIA, 1.560 O/A L 0.865-32UNS-2B 7659742 (19200)	EA	1								*	6	3		
N	X2-	D-			PIN, STRAIGHT 1/32 DIA, 3/32 L 505058 (21450)	EA	1										6	4	
N	X2-	D-			RETAINER 7659752 (19200)	EA	1											6	5
N	X1-	-			LENS 7659760 (19200)		1											6	6
N	X2-	D-			CELL 7659751 (19200)	EA	1											6	7
C	P-	D-		5305-823-5728	SETSCREW HDLS SOC DR, FP CRES NO. 4-48UNF-3A, 1/16 L MS1031-15 (96906)	EA	3								*	6	8		
C	P-	D-		1240-796-4176	PRISM ASSEMBLY OPTICAL INSTRUMENT 7659743 (19200)	EA	1								*	6	9		

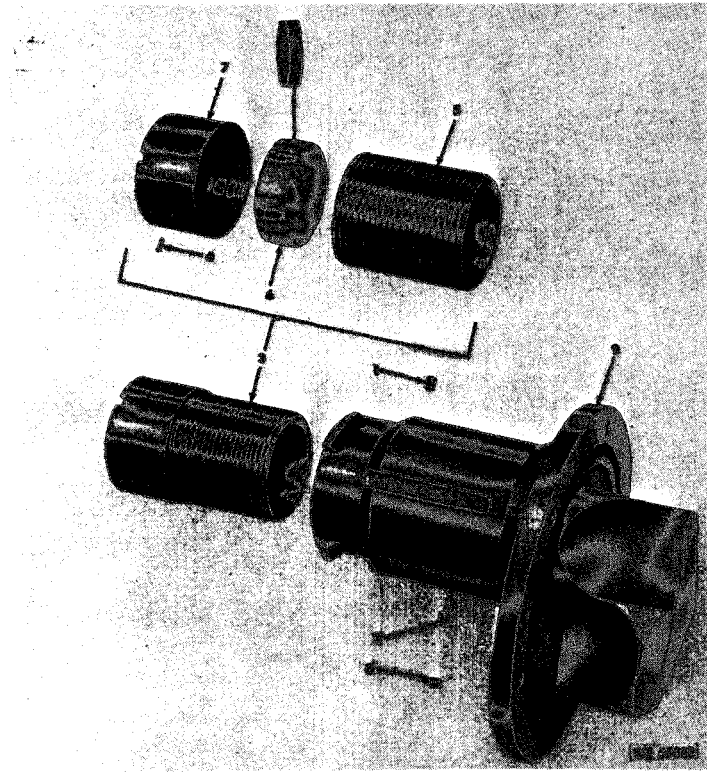

Figure 6. Cell assembly and prism assembly w/related parts

SECTION III SPECIAL TOOLS LIST

ACT ON CODE	(1) SOURCE MAINT AND RECOV			(2) FEDERAL STOCK NO.	(3) DESCRIPTION REFERENCE NUMBER & MFR CODE	(4) UNIT OF MEAS USABLE ON CODE	(5) QTY INC IN UNIT	(6) 30-DAY DS MAINT ALLOWANCE			(7) 30-DAY GS MAINT ALLOWANCE			(8) 1-YR ALW PER 100 EQUIP CNTGCTY	(9) DEPOT MAINT 100 ALW PER EQUIP	(10) ILLUSTRATION FIGURE (A) ITEM (B) NO. NO.		
	(A)	(B)	(C)					(A)	(B)	(C)	(A)	(B)	(C)					
TOOLS AND EQUIPMENT TOOLS																		
C	P-	D-		4931-730-6720	ADAPTER, TEST 8213875 (19200)	EA									*	7	-	
C	P-	C-		1240-441-0471	EQUIPMENT CARRYING CASE, TELESCOPE 8575980 (19200)	EA	*	*	*	*	*	*	*	*	*	8	-	
C	P-	C-		1240-796-4175	CLAMP ASSEMBLY 7659949 (19200)	EA	*	*	*	*	*	*	*	*	*	9	-	
C	P-	F-		1240-346-8701	LIGHT, INSTRUMENT M54 8246214 (19200)	EA	*	*	*	*	*	*	*	*	*	10	-	

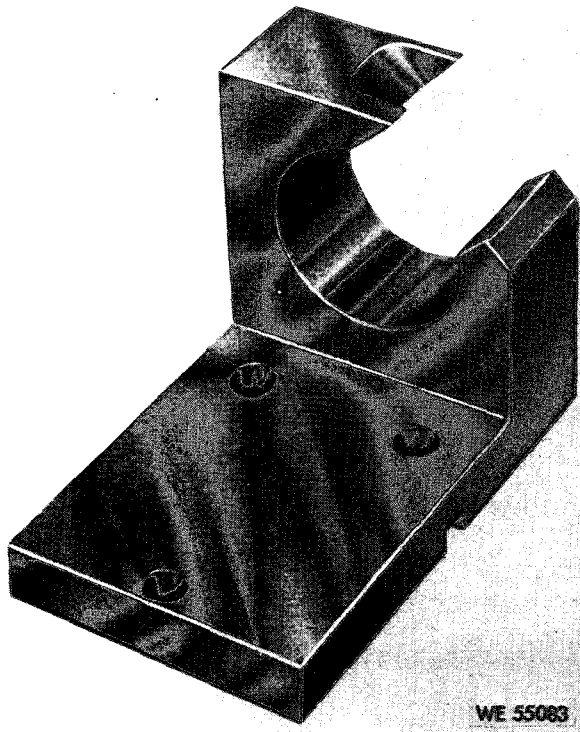
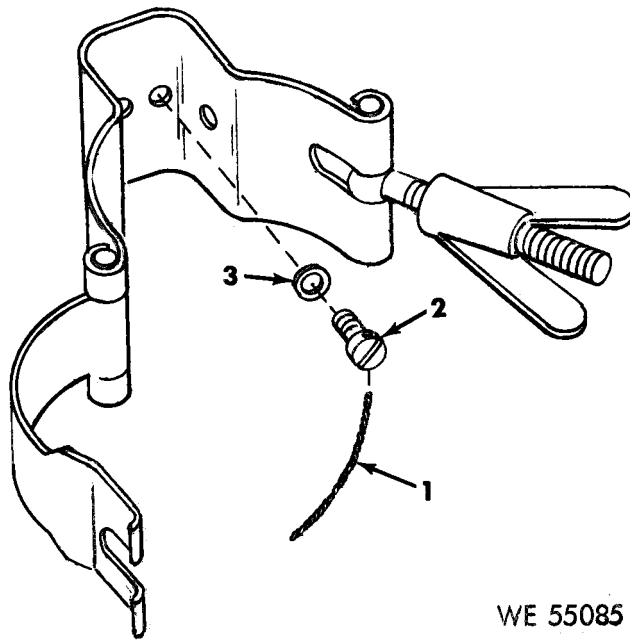

Figure 7. Adapter, test



Figure 8. Carrying case, telescope

ACT ON CODE	(1) SOURCE MAINT AND RECOV CODE (A) (B) (C) SOURCE MAINT RECOV			(2) FEDERAL STOCK NO.	(3) DESCRIPTION REFERENCE NUMBER & MFR CODE USABLE ON CODE	(4) UNIT OF MEAS	(5) QTY INC IN UNIT	(6) 30-DAY DS MAINT ALLOWANCE (A) (B) (C) 1-20 21-50 51-100			(7) 30-DAY GS MAINT ALLOWANCE (A) (B) (C) 1-20 21-50 51-100			(8) 1-YR ALW PER EQUIP CNTGCTY	(9) DEPOT MAINT ALW PER EQUIP	(10) ILLUSTRATION (A) (B) FIGURE ITEM NO. NO.		
	REPAIR PARTS FOR EQUIPMENT CLAMP ASSEMBLY 7659949																	
	N	P-	O-		9505-684-0982	WIRE,LOCK CRES 0.041 DIA 1 LB SPOOL QQW423 (81348)	SL	V	*	*	*	*	*	*	*	*		9
N	P-	O-		5305-912-4818	SCREW, MACHINE DR, FILH, SLTD CRES, PSVT FNSH NO. 10-32UNF-2A, 3/8 L MS35276-261 (96906)	EA	2	*	*	*	*	*	*	*	*		9	2
N	P-	O-		5310-933-8120	WASHER,LOCK SPR,HLCL,CRES,PSVT FNSH 0.194 ID,0.334 OD,0.047 THK NO. 10 SCR MS35338-138 (96906)	EA	2	*	*	*	*	*	*	*	*		9	3



WE 55085

Figure 9. Clamp assembly

ACT ON CODE	(1) SOURCE MAINT AND RECOV CODE (A) (B) (C) SOURCE MAINT RECOV			(2) FEDERAL STOCK NO.	(3) DESCRIPTION REFERENCE NUMBER & MFR CODE LIGHT INSTRUMENT M54 8246214	(4) UNIT OF MEAS	(5) QTY INC IN UNIT	(6) 30-DAY DS MAINT ALLOWANCE (A) (B) (C) 1-20 21-50 51-100			(7) 30-DAY GS MAINT ALLOWANCE (A) (B) (C) 1-20 21-50 51-100			(8) 1-YR ALW PER EQUIP CNTGCV	(9) DEPOT MAINT ALW PER EQUIP	(10) ILLUSTRATION (A) (B) FIGURE ITEM NO. NO.	
	USABLE ON CODE																
N	P-	O-		1290-764-1600	BRACKET 7641600 (19200)	EA	1	*	*	*	*	*	*	*	*	10	1
C	P-	O-		6240-635-9800	LAMP, INCANDESCENT 3V, 0.19 AMP, S TUNG FIL, C-2R SPL THD B, T-1-1/4 BULB, NO. 325 193145 (21450)	EA	1	*	*	*	*	*	*	*	*	10	2

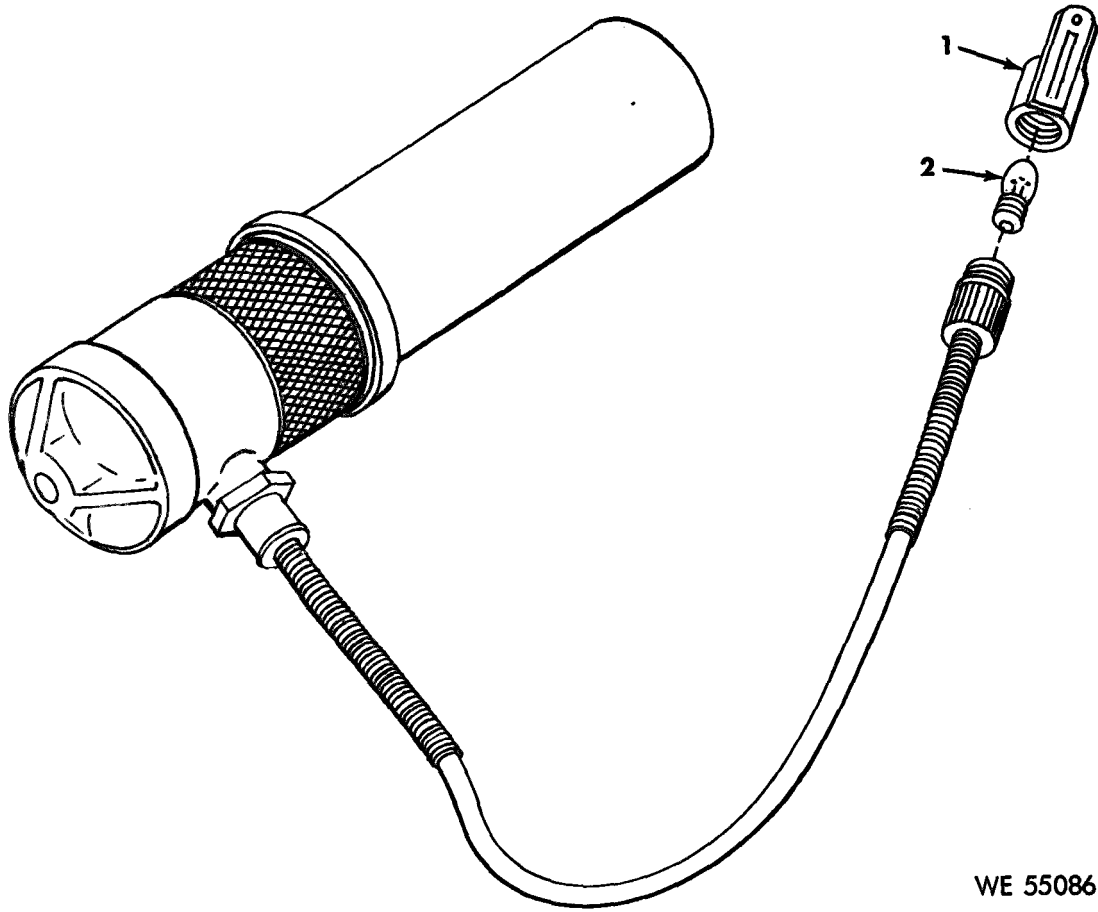

WE 55086

Figure 10. Light, instrument M54

Section IV FEDERAL STOCK NUMBER AND REFERENCE NUMBER INDEX

STOCK	N	FIGURE NO	ITEM NO	STOCK NUMBER	FIGURE NO	ITEM NO
1240-346-8701		10		5305-057-0498	2	4
1240		3	6	5305-057-0511	2	2
1240-441-0471		8		5305-068-6708	3	1
1240-504-9890		3	7	5305-527-5737	6	1
1240-796-4175		9		5305-753-7062	3	3
1240-796-4176		6	9	5305-823-5728	6	8
1240-812-1751		6	3	5305-851-2287	6	2
1240-812-1752		3	4	5305-912-4818	9	2
1240-812-1754		2	1	5310-933-8118	2	3
1240-815-8187		3	5	5310-933-8120	9	3
1290-764-1600		10	1	6240-635-9800	10	2
4931-730-6720		7		9505-684-0982	9	1
5305		2	5	9905-454-9020	3	8

REFERENCENUMBER	MFG CODE	FIG NO	ITEM NO	REFERENCENUMBER	MFG CODE	FIG NO	ITEM NO
MS35276-261	96906	9	2	7659746	19200	4	5
MS35338-135	96906	2	3	7659747	00000	4	3
MS35338-138	96906	9	3	7659748	00000	4	1
MS51024-18	96906	6	2	7659749	19200	5	4
MS51031-15	96906	6	8	7659750	19200	5	1
MS5103	96906	6	1	7659751	19200	6	7
MS51038-16	96906	3	1	7659752	19200	6	5
MS51838-2	96906	2	4	7659753	19200	3	8
MS51957-59	96906	2	5	76597	00000	5	2
MS51958-14	96906	2	2	7659759	19200	5	3
QQW423	81348	9	1	7659760	19200	6	6
I93145	21450	10	2	7659761	19200	4	2
5049890	19200	3	7	7659949	19200	9	
505058	21450	6	4	7660663	19200	3	6
541823	00000	3	3	8213875	19200	7	
7641600	19200	10	1	8246214	19200	10	
7659741	19200	3	2	8575980	19200	8	
7659742	19200	6	3	8634481	19200	3	5
7659743	19200	6	9	8634482	19200	3	4
7659745	00000	3	9	8634483	19200	2	1

By Order of the Secretary of the Army:

Official:

W. C. WESTMORELAND,
General, United States Army,
Chief of Staff.

VERNE L. BOWERS,
Major General, United States Army,
The Adjutant General.

DISTRIBUTION:

To be distributed in accordance with DA Form 12-41, (qty rqr block no. 140)
Direct and General Support maintenance requirements for Telescope.